



→ Fold-away lift for trucks, trailers & semi-trailers

DH-RM(C).20 • 1500 - 2000 kg



The DH-RM.20 is an extremely versatile and robust lift, equipped with a **wide arm center and 2 lift cylinders**. It offers a **level ride** between the vehicle floor and the ground, plus **automatic tilt at ground level**. This **premium lift** is the best suited fold-away lift for demanding distribution, incl. high stack pallets and roll cages.

The fold-away storage of this lift offers free access to the cargo space, and is ideal for operations needing frequent access to **loading docks**. The DH-RM.20 can be mounted to a wide range of trucks and (semi-)trailers, incl. refrigerated bodies [option OAP628].

There are 2 executions: the DH-RM.20 with fixed stabilizers, and the DH-RMC.20 with tilt cylinders and **adjustable platform orientation**. Power-down is available as an option [OAH025.1]

The special model DH-RMV.20 is specially designed for truck-trailer combinations.

Lift capacity

CAP	CG	LM
1500 kg	600 mm	9 kNm
2000 kg	600 mm	12 kNm

Weights [see pg. 19]

ALU / ALU		STEEL / ALU	
1300 mm	385 kg	1300 mm	410 kg
1500 mm	395 kg	1500 mm	420 kg
1600 mm	400 kg	1600 mm	425 kg

Weights incl. CE bumper

Heavy duty fold-away lift with 2 lift cylinders

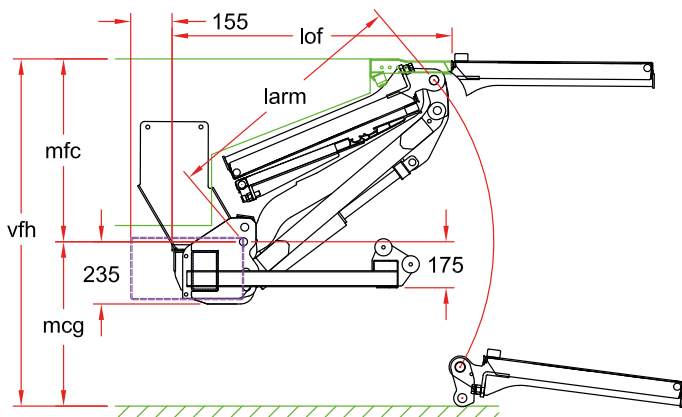

Fitting dimensions

larm		840	940	1000
vfh max.		1360	1500	1590
vfh min. loaded	(2)	965	1065 (3)	1065 (3)
mfc max.		685	760	810
mfc min.		500	500	500
mfcg max.		675	740	780
lof	at mfc max.	905	975	1010
lof	at mfc min.	1065	1180	1250
pd max.		1300	1600 (1)	1600 (1)

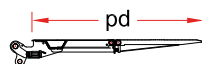

(1) For 2000 kg - 1600 mm, it is strongly recommended to use the model DH-RM.25

(2) Only considering height required to unfold platform, not the ground clearance under the lift frame

(3) With the 1500 mm platform. Add 50 mm for 1600 mm platform

Technical specifications

Lift frame	150 x 150 mm
Cylinders	2 lift cylinders + 2 fixed stabilisers (DH-RM) or 2 tilt cylinders (DH-RMC)
Type of ride [see pg. 8-9]	Wedged platform, level ride with automatic tilt at ground level
Platform material	Steel / Alu • Alu / Alu
Standard platform depths	1300 - 1500 - 1600 mm
Standard platform widths	<ul style="list-style-type: none"> • 2000 - 2150 - 2200 mm • 2350 mm on request [option OAP603]
Lift arm lengths	840 - 940 - 1000 mm
Lift arm widths	1135 - 1385 mm
Mounting	<ul style="list-style-type: none"> • Rear floor plate [OAM003] • N-A bed extension plate + side ladders [OAM051 + OAM052.LR] • Adapted for refrigerated floor [option OAP628]
Std. control unit [see pg. 10]	OAE030.BT
Standard finish of the lift frame	Hot-dip zinc plated finish [OAT104]